

The robust 5-finger timber grab combines the strength of the demolition and sorting grabs of the D-series with highly wear resistant timber grab tines. For excavators of up to 15t/33000lbs, 20t/ 44000lbs or 27t/59400lbs operating weight - ideal for forestry works, rolled lumber, special demolition tasks and pile foundations.

- ▷ Kinematics of tines avoids clamping of material - made of highly wear resistant material (500HB).
- ▷ **Branches with only 100mm/3.9in diameter can be gripped firmly.**
- ▷ **Robust, fully integrated rotation** with two motors and sturdy slewing ring to withstand external forces. Hydraulic quick exchange systems are mountable directly. **Integrated pressure relief valve** against overcharge.
- ▷ **Exceptional closing forces** through two horizontally positioned hydraulic cylinders that are protected by the bucket carrier.
- ▷ **Cylinders are hydraulically cushioned.**



D20H-T

Timber Grab D15H-T / D20H-T / D27H-T

Type	Width E (mm/in)	Opening A (mm/in)	Log-Ø D min. (mm/in)	Log-Ø D max. (mm/in)	Height C max. (mm/in)	Weight (kg/lbs)	Load capacity (kg/lbs)	Closing force (kN/lbf)	Torque (Nm/ft.lbs)	Operating weight (t/lbs)
D15H-T	740/ 29.1	740/ 29.1	100/ 3.9	500/ 19.7	1040/ 40.9	690/ 1518	3000/ 6600	37/ 8140	5700/ 5203.8	11-15/ 24200-33000
D20H-T	825/ 32.5	825/ 32.5	100/ 3.9	580/ 22.8	1350/ 53.1	1045/ 2299	4000/ 8800	42/ 9240	5700/ 5203.8	14-20/ 30800-44000
D27H-T	1000/ 39.4	1000/ 39.4	125/ 4.9	700/ 27.6	1655/ 65.2	1665/ 3663	6000/ 13200	59/ 12980	5700/ 5203.8	18-27/ 39600-59400

Package consists of: timber grab, integrated rotation with sturdy slewing ring and non-return valve

Accessories

Type	Description
KM 690 15t	adapter for rigid mounting - up to 15t/33000lbs
KM 690 20t	adapter for rigid mounting - up to 20t/44000lbs
KM 690 27t	adapter for rigid mounting - up to 27t/59400lbs
OQ	bolt-on-adapter for Oilquick OQ - 5t to 70t/11000lbs to 154000lbs
KSW10 rigid	bolt-on-adapter for system L-Lock KMS10L/KHS10L - up to 19t/41800lbs
KSW21/25 rigid	bolt-on-adapter for system L-Lock KMS21/25L / KHS21/25L - up to 40t/88000lbs
	adapters for quick change systems from other manufacturers or different sizes available on request

Requirements of carrier machine

	D15H-T	D20H-T	D27H-T
Operating pressure (open/close):	32 MPa (320 bar) / 4640psi	32 MPa (320 bar) / 4640psi	35 MPa (350 bar) / 5070psi
Pump capacity (open/close):	75 - max. 150 l/min/ 20 - max. 40GPM	75 - max. 150 l/min/ 20 - max. 40GPM	75 - max. 150 l/min/ 20 - max. 40GPM
Hydraulic connection (open/close):	G 3/4" / G 1/2"	G 3/4" / G 1/2"	G 1" / G 1/2"
Operating pressure (rotate):	17 Mpa (170 bar) / 2460psi	17 Mpa (170 bar) / 2460psi	17 Mpa (170 bar) / 2460psi
Pump capacity (rotate):	25 - max. 60 l/min/ 6.5 - max. 16GPM	25 - max. 60 l/min/ 6.5 - max. 16GPM	25 - max. 60 l/min/ 6.5 - max. 16GPM

Technical drawing

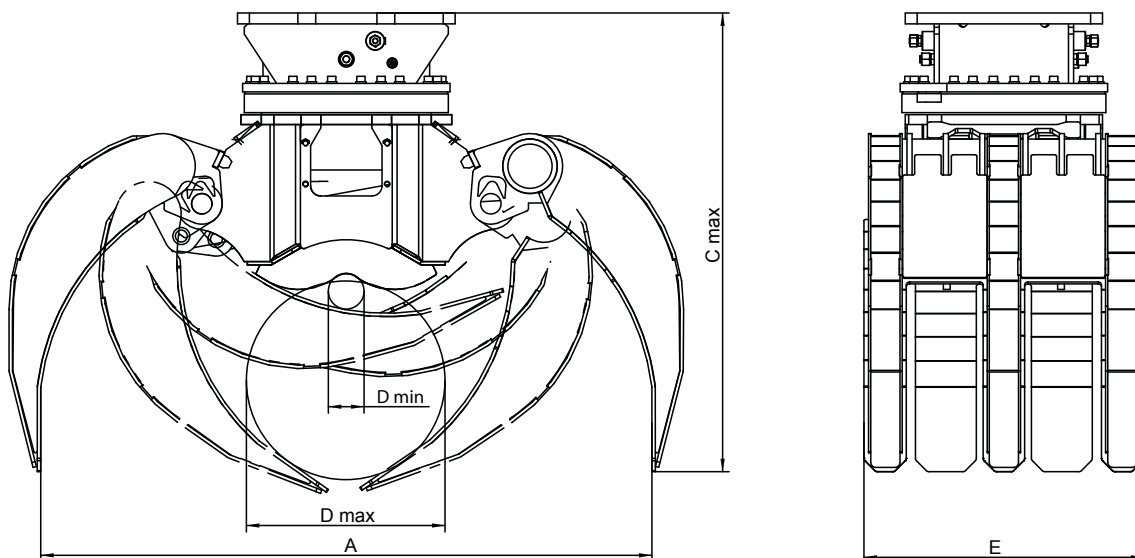

D20H-T

The bucket shells of the **HPXdrive** are bolted to the shafts, and therefore it is very easy to replace them with another set of shells. Different types of shells for different applications can be refitted onto the driving unit, e.g. clamshell bucket, rock grab, timber grab, hay and forestry grab and multi purpose clamshell. Other types of shells are available on request.

The interchangeable shells are delivered with an exchange aid that guarantees that the **HPXdrive** can be positioned with ease.

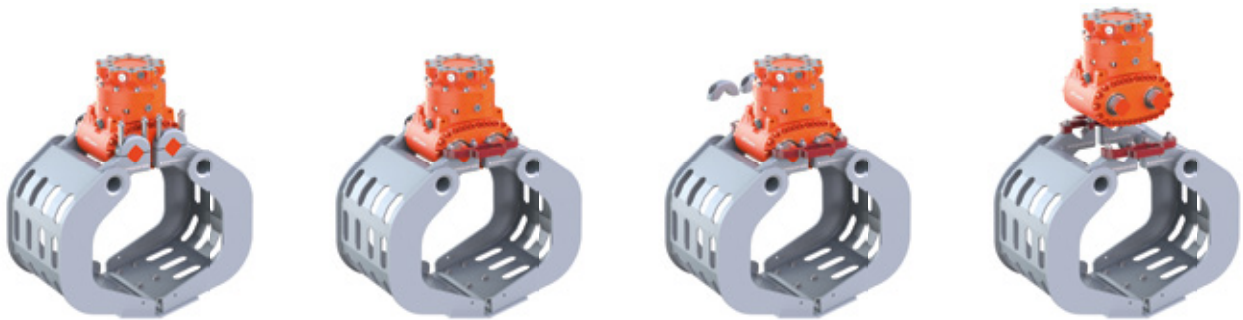

Type	Operating weight (t/lbs)	Width (mm/in)	Volume (liter/c.y.)	Number of teeth	Weight (kg/lbs)	Load capacity (kg/lbs)
------	--------------------------	---------------	---------------------	-----------------	-----------------	------------------------

Exchangeable Shells for Clamshell Buckets

C05HPX-40S	3-5 / 6600-11000	400 / 15.7	115 / 0.15	4	100 / 220	3000 / 6600
C05HPX-45S	3-5 / 6600-11000	450 / 17.7	130 / 0.17	4	125 / 275	3000 / 6600
C05HPX-50S	3-5 / 6600-11000	500 / 19.6	140 / 0.18	4	130 / 286	3000 / 6600
C05HPX-60S	3-5 / 6600-11000	600 / 23.6	170 / 0.22	6	145 / 319	3000 / 6600
C05HPX-80S	3-5 / 6600-11000	800 / 31.4	230 / 0.30	6	180 / 396	3000 / 6600
C08HPX-40S	5-8 / 11000-17600	400 / 15.7	145 / 0.19	4	110 / 242	3000 / 6600
C08HPX-45S	5-8 / 11000-17600	450 / 17.7	160 / 0.21	4	135 / 297	3000 / 6600
C08HPX-50S	5-8 / 11000-17600	500 / 19.6	180 / 0.24	4	145 / 319	3000 / 6600
C08HPX-60S	5-8 / 11000-17600	600 / 23.6	220 / 0.29	6	150 / 330	3000 / 6600
C08HPX-80S	5-8 / 11000-17600	800 / 31.4	300 / 0.39	6	195 / 429	3000 / 6600



Exchangeable Shells for Demolition and Sorting Grabs

D04HPX-40S	2-4 / 4400-8800	420 / 16.5	60 / 0.08	-	94 / 206	1500* & 1000** 3300* & 2200**
D06HPX-45S	3-6 / 6600-13200	470 / 18.5	150 / 0.20	-	126 / 277	2000* & 1000** 4400* & 2200**
D09HPX-50S	6-9 / 13200-19800	500 / 19.6	220 / 0.29	-	183 / 402	2500* & 1000** 5500* & 2200**

*Load capacity at form locking / **Load capacity at friction locking



Exchangeable Shells for Multi Purpose Grabs

A04HPX-40S	2-4 / 4400-8800	386 / 15.1	70 / 0.09	3	100 / 220	1500* & 1000** 3300* & 2200**
A06HPX-45S	3-6 / 6600-13200	450 / 17.7	145 / 0.19	5	125 / 275	2000* & 1000** 4400* & 2200**
A09HPX-50S	6-9 / 13200-19800	500 / 19.6	210 / 0.27	5	186 / 409	2500* & 1000** 5500* & 2200**

*Load capacity at form locking / **Load capacity at friction locking



Exchangeable Shells for 3-Finger Timber Grabs

T06HPX-3ZS	3-5 / 6600-11000	375 / 14.7	-	-	95 / 209	1000 / 2200
T09HPX-3ZS	5-9 / 11000-19800	375 / 14.7	-	-	95 / 209	2000 / 4400



Exchangeable Shells for Rock Grabs

R05HPX-0,16S	3-5 / 6600-11000	400 / 15.7	0,16 m ² / 0,11 cords	-	70 / 154	1000 / 2200
R08HPX-0,16S	5-8 / 11000-17600	400 / 15.7	0,16 m ² / 0,11 cords	-	70 / 154	1000 / 2200



Package consists of: exchangeable shells, bolt-on teeth (for clamshell buckets), shell exchange support kit

Note: The KINSHOFER **HPXdrive** shells can only be used in combination with KINSHOFER rotator and drive unit **HPXdrive**

T06 - T09HPX-3Z 3-Finger Timber Grab with *HPXdrive* 3-9t / 6600-19800lbs

With the 3-finger timber grab for logging and forestry tasks with the low maintenance *HPXdrive* for excavators with up to 6t/13200lbs or 9t/19800lbs operating weight, even logs with only 90mm/3.5in diameter can be gripped firmly. Ideal also for the handling of brushwood and branches.

- ▷ ***HPXdrive*** – the revolutionary concept for hydraulically operated grabs! The rotation of the arms of the grab is generated by two hollow shafts, which run opposed and have a helix thread, hydraulically driven by a single piston. **No hydraulic cylinder required!**
- ▷ **50% longer life cycle.** The drive unit runs in a permanent oil bath – no lubrication necessary. Resistant against dirt and blows, due to the compact design.
- ▷ **Constant closing force** during the entire operation.
- ▷ Different applications possible thanks to easy **shell exchange system.**
- ▷ **Rigid mounting and flat 360° rotator for precise positioning.**
- ▷ **Arms made of cutting edge material 500HB.**



T09HPX-3Z

Timber Grab T06HPX/T09HPX

Type	Width E (mm/in)	Opening A (mm/in)	Height C max. (mm/in)	Gripping range D min. - D max. (Ø mm/in)	Weight (kg/lbs)	Load capacity (kg/lbs)	Closing force (kN/lbf)	Operating weight (t/lbs)
T06HPX-3Z	378 / 14.9	1240 / 48.8	1050 / 41.3	90 / 3.5 - 560 / 22	310 / 682	1000 / 2200	17 / 3740	3-6 / 6600-13200
T09HPX-3Z	375 / 14.7	1240 / 48.8	1035 / 40.7	90 / 3.5 - 560 / 22	320 / 704	2000 / 4400	17 / 3740	5-9 / 11000-19800

Package consists of: timber grab, **KINSHOFER** rotator (T06HPX: KM 10 F214/180 / T09HPX: KM 15 F273/273) and non-return valve

KINSHOFER Rotator

Integrated in a single unit with the *HPXdrive*, no more connecting hoses. Continuous rotation. Overload protection ensured by pressure relief valves.

Type	Upper dimension (hole/Ø-hole pattern) (mm/in)	Torque (Nm/ft.lbs)	Bending moment max. (Nm/ft.lbs)
T06HPX: KM 10 F214/180	6 x M16; Ø 180 / 7	1000 / 737	12000 / 8850
T09HPX: KM 15 F273/273	10 x M16; Ø 273 / 10.7	2000 / 1475	50000 / 36875

Accessories

Type	Description
KM 691 8t	adapter plate for specific solutions – up to 8t/17600lbs
KM 690 8t	adapter for rigid mounting – up to 8t/17600lbs
OQ45/4 rigid	bolt-on adapter for Oilquick OQ45 - up to 12t/26400lbs
KSW03 rigid	bolt-on adapter for system L-Lock KMS03L/KHS03L for rigid mounting – up to 6t/13200lbs
KSW08 rigid	bolt-on adapter for system L-Lock KMS08L/KHS08L for rigid mounting – up to 12t/26400lbs
KM 980-2 2t-8t c	adapters for quick change systems from other manufacturers or different sizes on request
	solenoid valve for additional circuit, up to 26MPa/3770psi, incl. parts and mounting

Requirements of carrier machine

Operating pressure at pump capacity (open/close):

26 MPa (260 bar) at max. 75 l/min / 3745 psi at max. 20 GPM

26 - 32 MPa (260 - 320 bar) at max. 40 l/min / 3745 - 4640 psi at max. 10.6 GPM

Operating pressure at pump capacity (rotate):

32 MPa (320 bar) at 20 - 50 l/min / 4640 psi at 5.3 - 13 GPM

Technical drawings

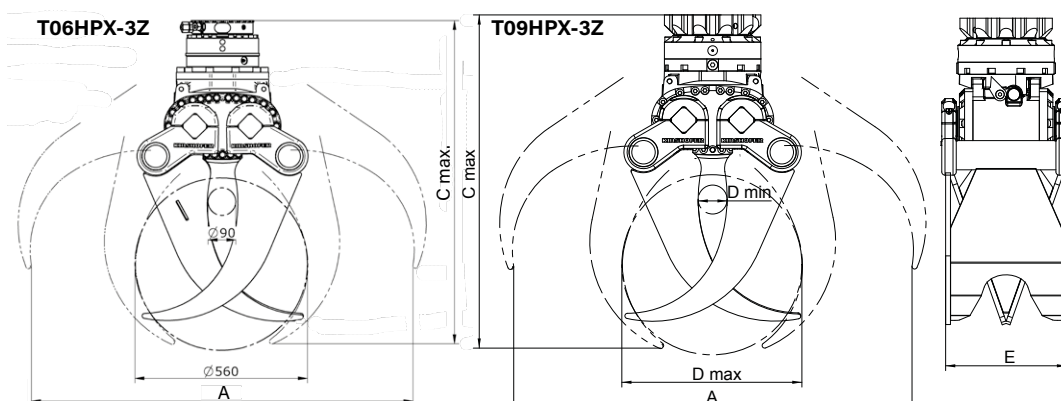

Free extension
of warranty
kinshofer.com/service

The robust 4-finger timber grab unifies the proven KINSHOFER rotator with sturdy logging tines for excavators with up to 12t/26400lbs operating weight. Ideal also for forestry enterprises handling windfalls or when realizing special demolition or pile foundation tasks.

- ▷ The kinematics of the tines **avoid the unintended clamping of material.**
- ▷ **Logs with 110mm/4.3in to 590mm/23.2in in diameter** can be gripped.
- ▷ **Robust, fully integrated rotation with two motors. Integrated pressure relief valve against overcharge.**
- ▷ **High closing force** achieved by two hydraulic cylinders. **Robust bearings** are made for high forces.



Timber Grab T12H

Type	Width E (mm/in)	Opening A (mm/in)	Height C min. (mm/in)	Log-Ø (mm/in)	Volume (m ³ /cord)	Weight (kg/lbs)	Load capacity (kg/lbs)	Closing force (kN/lbf)
T12H-60	600 / 23.6	1850 / 72.8	1135 / 44.6	110-590 / 4.3-23.2	0,40 / 0.27	610 / 1342	3000 / 6600	16 / 3520

Package consists of: timber grab, **KINSHOFER** rotation and non-return valve

Accessories

Type	Description
KM 690 15t	adapter for rigid mounting – up to 15t/33000lbs
KSW08 rigid	bolt-on adapter for system L-Lock KMS08L/KHS08L for rigid mounting – up to 12t/26400lbs
OQ45/4 rigid	bolt-on adapter for OilQuick OQ45 – up to 12t/26400lbs
	adapters for quick change systems from other manufacturers or different sizes on request

Requirements of carrier machine

Operating pressure (open/close):	max. 28 MPa (280 bar) / 4060 psi
Operating pressure (rotate):	14 - 25 MPa (140 - 250 bar) / 2030 - 3620 psi
Recommended pump capacity (rotate):	25 - 75 l/min / 6.5 - 20 GPM

Technical drawing

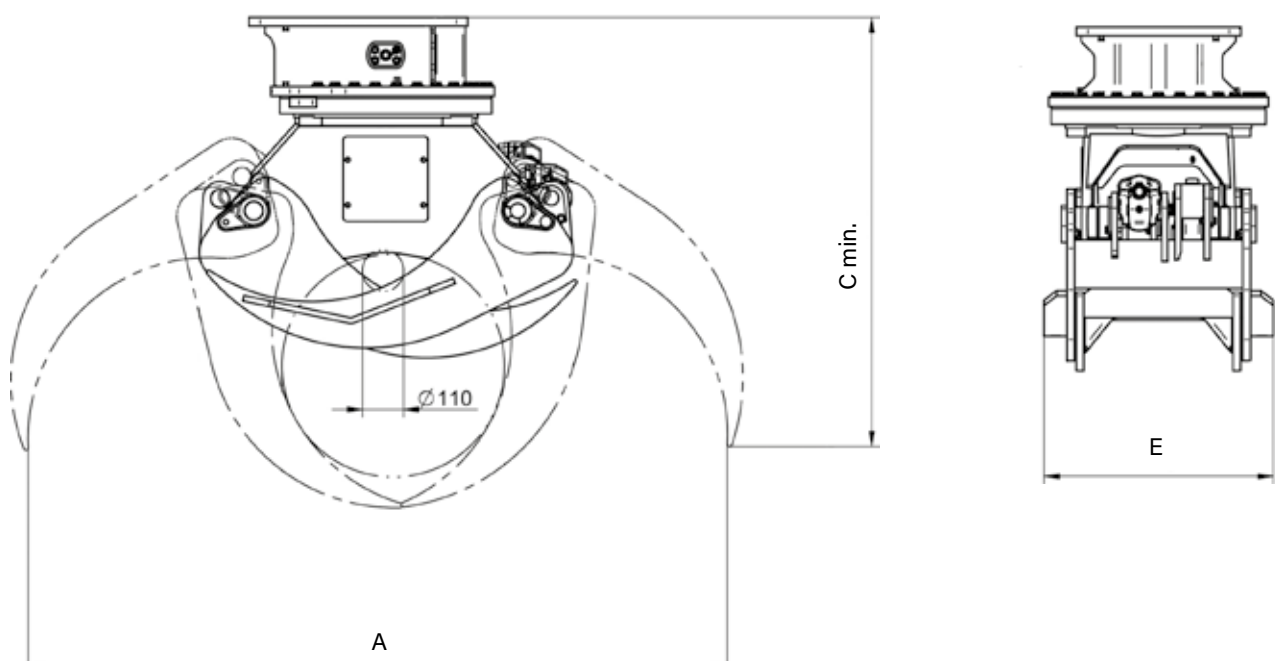

Timber grabs for mobile excavators and static excavators from 13t/ 28600lbs to 20t/44000lbs operating weight.

- ▷ **Long life** is ensured due to the use of 500HB steel in the manufacture of cutting edges.
- ▷ **Reduced wear** resulting from generously dimensioned bearing system.
- ▷ **Rotator integrated** in the gripping arm carrier
- ▷ **Excellent closing characteristics.**
- ▷ **360° endless rotation** mounted directly without short hoses.
- ▷ **Hydraulically cushioned cylinders.**



Timber Grab T20V								
Type	Width E	Opening A	Height C max.	Log-Ø F min.	Volume	Weight	Load capacity	Closing force
	(mm/in)	(mm/in)	(mm/in)	(mm in)	(m ² / ft ²)	(kg/lbs)	(kg/lbs)	(kN/lbf)
T20V-0,60	490 / 19.3	1970 / 77.6	2110 / 83.1	100 / 3.9	0,60 / 6.5	610 / 1342	4500 / 9900	25 / 5500
T20V-0,80	490 / 19.3	2180 / 85.8	2255 / 88.8	120 / 4.7	0,80 / 8.6	635 / 1397	4500 / 9900	22 / 4840
T20V-1,00	490 / 19.3	2350 / 92.5	2370 / 93.3	140 / 5.5	1,00 / 10.8	660 / 1452	4500 / 9900	20 / 4400
T20V-1,25	490 / 19.3	2500 / 98.4	2500 / 98.4	160 / 6.3	1,25 / 14.5	685 / 1507	4500 / 9900	19 / 4180

Package consists of: timber grab, **KINSHOFER** rotator, non-return valve and hose guard

KINSHOFER Rotator

Continuous rotation and two oil passages. Overload protection is ensured by pressure relief valves.

Type	Upper connection (width x pin-Ø) (mm/in)	Torque (Nm/ft.lbs)	Bending moment max. (Nm/ft.lbs)
KM 10 F275-60	125 x 60 / 4.9 x 2.4	2000 / 10325	14000 / 10325

Accessories

Type	Description
KM 501 13t-25t	upper suspension without pendulum damper
KM 511 13t-25t	upper suspension with pendulum damper
KM 510 13t-25t	single pendulum damper
KSW10 cardanic	adapter for system L-Lock KMS10L/KHS10L incl. cardan link excl. pendulum damper – up to 19t/418000lbs adapters for quick change systems from other manufacturers or different sizes on request

Requirements of carrier machine

Operating pressure (open/close):	max. 35 MPa (350 bar) / 5070psi
Pump capacity (open/close):	75 - max. 150 l/min / 20 - max. 40GPM
Operating pressure (rotate):	max. 32 MPa (320 bar) / 4640psi
Pump capacity (rotate):	20 - max. 50 l/min / 5 - max. 13GPM

Technical drawing

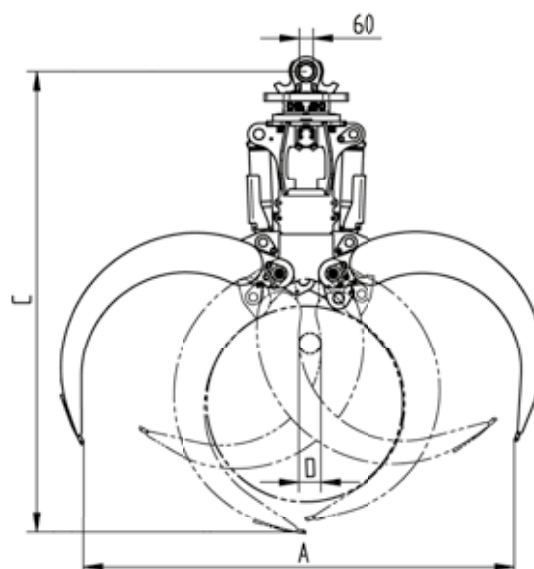

Timber grabs for mobile excavators and static excavators from 20t/44000lbs to 30t/66000lbs operating weight.

- ▷ **Long life** is ensured due to the use of 400HB steel in the manufacture of cutting edges.
- ▷ **Reduced wear** resulting from generously dimensioned bearing system.
- ▷ **Rotator integrated** in the gripping arm carrier
- ▷ **Excellent closing characteristics.**
- ▷ **360° endless rotation** mounted directly without short hoses.
- ▷ **Hydraulically cushioned cylinders.**



Timber Grab T30V									
Type	Width E	Opening A	Height C max.	Log-Ø F min.	Log-Ø D max.	Volume	Weight	Load capacity	Closing force
	(mm/in)	(mm/in)	(mm/in)	(mm/in)	(mm/in)	(m ² /ft ²)	(kg/lbs)	(kg/lbs)	(kN/lbf)
T30V-0,50	720 / 28.3	2185 / 86.0	2215 / 87.2	100 / 3.9	800 / 31.5	0,50 / 5.4	900 / 1980	6000 / 13200	38 / 8360
T30V-0,60	720 / 28.3	2335 / 91.9	2290 / 90.2	110 / 4.3	870 / 34.3	0,60 / 6.5	920 / 2024	6000 / 13200	36 / 7920
T30V-0,80	720 / 28.3	2605 / 102.6	2425 / 95.5	120 / 4.7	1000 / 39.4	0,80 / 8.6	960 / 2212	6000 / 13200	34 / 7480
T30V-1,00	720 / 28.3	2850 / 112.2	2550 / 100.4	140 / 5.5	1125 / 44.3	1,00 / 10.8	980 / 2156	6000 / 13200	32 / 7040
T30V-1,25	720 / 28.3	3135 / 123.4	2695 / 106.1	150 / 5.9	1260 / 49.6	1,25 / 13.5	1020 / 2244	6000 / 13200	30 / 6600

Package consists of: timber grab, **KINSHOFER** rotator with hose guard, non-return valve

KINSHOFER Rotator

Continuous rotation and two oil passages. Overload protection is ensured by pressure relief valves.

Type	Upper connection (width x pin-Ø) (mm/in)	Torque (Nm/ft.lbs)	Bending moment max. (Nm/ft.lbs)
KM 15 F273-70	180 / Ø 70 / 7.1/ 2.8	2000 / 1475	50000 / 36875

Accessories

Type	Description
KM 501 19t-60t	upper suspension without pendulum damper
KM 511 19t-60t	upper suspension with pendulum damper
KM 510 19t-60t	single pendulum damper
KSW21/25 cardanic	adapter for system L-Lock KMS21/25L / KHS21/25L incl. cardan link excl. pendulum damper
	adapters for quick change systems from other manufacturers or different sizes on request

Requirements of carrier machine

Operating pressure (open/close):	max. 35 MPa (350 bar) / 5070psi
Pump capacity (open/close):	75 - max. 150 l/min / 20 - max. 40GPM
Operating pressure (rotate):	max. 35 MPa (350 bar) / 5070psi
Pump capacity (rotate):	20 - max. 50 l/min / 5 - max. 13GPM

Technical drawing

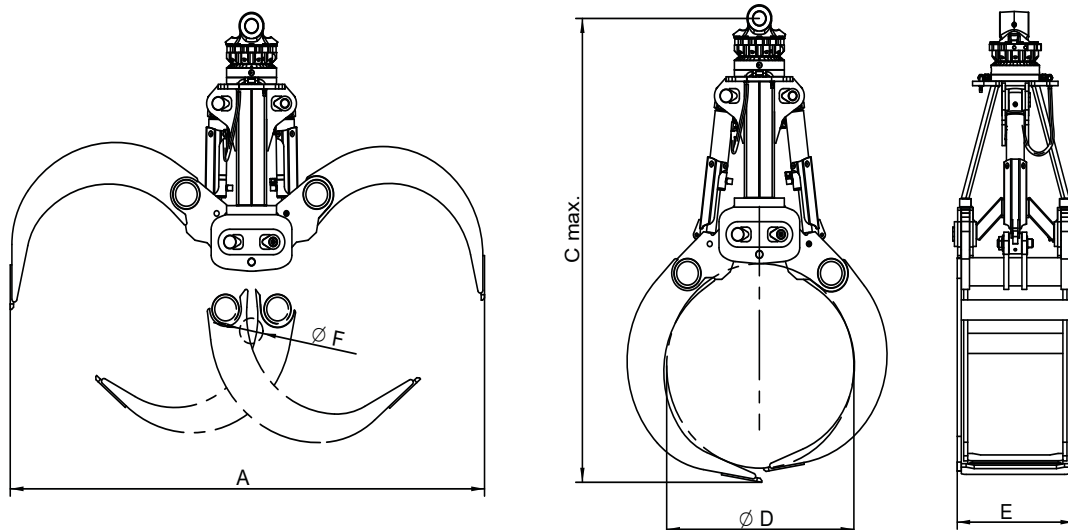

Timber grab with three tines for mobile and static excavators from 20t/ 44000lbs to 30t/66000lbs operating weight.

- ▷ **Long life** is ensured due to the use of 500HB steel in the manufacture of cutting edges
- ▷ Without compensation rod for **good clamping behavior**.
- ▷ **Robust, integrated heavy duty rotation** with hose guard.
- ▷ **Excellent closing characteristics** and large opening.
- ▷ **High closing forces** (53kN/11660lbf at an operating pressure of 35MPa/5070psi).



Timber Grab T30VHD-3Z								
Type	Width E	Opening A	Height C max.	Height C min.	Grip. range D min.	Volume	Weight	Load capacity
	(mm/in)	(mm/in)	(mm/in)	(mm/in)	(mm/in)	(m ² /ft ²)	(kg/lbs)	(kg/lbs)
T30VHD-0,75-3Z	586 / 23.1	1945 / 76.6	1830 / 72	1595 / 62.8	215 / 8.5	0,75 / 8.1	957 / 2105.4	7000 /15400

Package consists of: timber grab, **KINSHOFER** rotation with sturdy slewing ring and hose guard, non-return valve

Accessories

Type	Description
KM 501 RD50	upper suspension without pendulum damper
KSW21/25 cardanic	adapter for system L-Lock KMS21/25L / KHS21/25L incl. cardan link excl. pendulum damper
	adapters for quick change systems from other manufacturers or different sizes on request

Requirements of carrier machine

Operating pressure (open/close):	max. 35 MPa (350 bar) / 5070psi
Pump capacity (open/close):	75 - max. 150 l/min / 20 - max. 40GPM
Operating pressure (rotate):	max. 17 MPa (170 bar) / 2460psi
Pump capacity (rotate):	25 - max. 60 l/min / 6.5 - max. 16GPM

Technical drawing

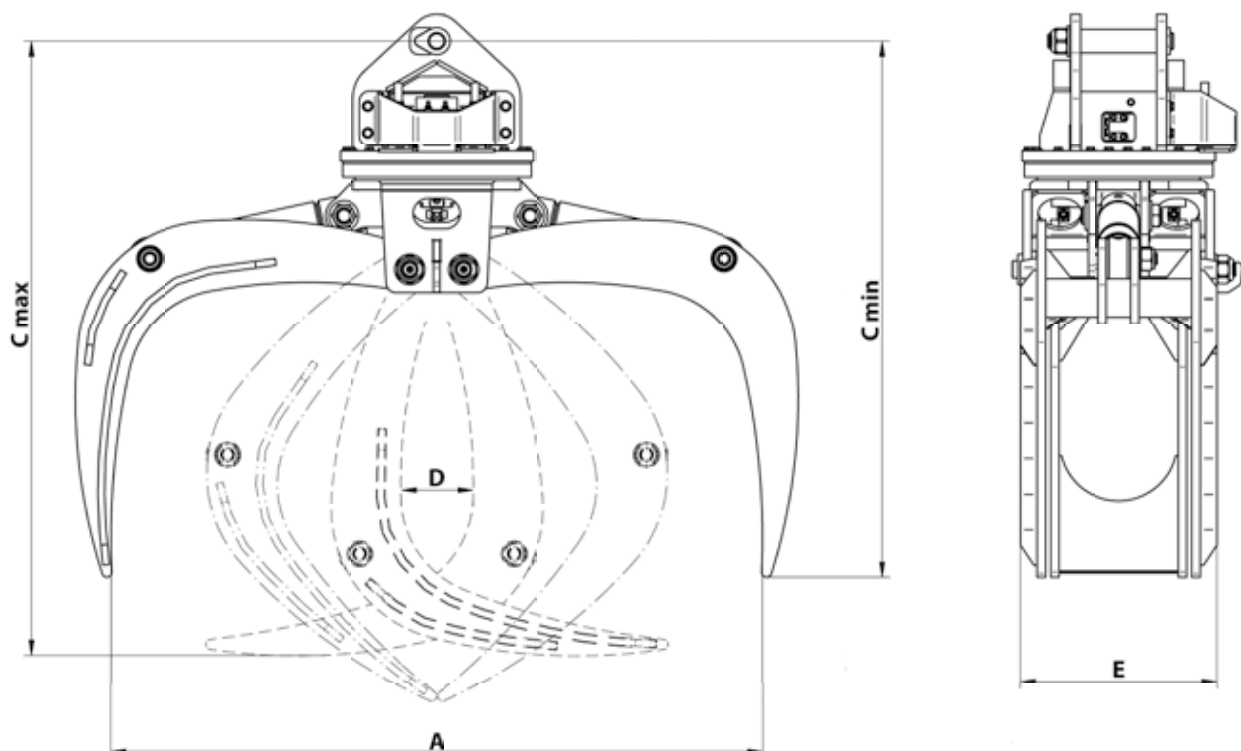

Timber grab for mobile excavators and static excavators from 25t/ 55000lbs to 40t/88000lbs operating weight.

- ▷ **Long life** is ensured due to the use of 400HB steel in the manufacture of cutting edges.
- ▷ **Reduced wear** resulting from generously dimensioned bearing system.
- ▷ **Robust rotation** integrated in the center part, with hose guard.
- ▷ Optimal plunge into the log pile thanks to the **large opening**.
- ▷ Cylinder with **counter-balance valve** and end position damping.
- ▷ **High closing forces** of up to 45kN/9900lbs at an operating pressure of 35MPa/5075psi, varies depending on width.



Timber Grab T40VHD

Type	Opening A (mm/in)	Height C max. (mm/in)	Log-Ø F min. (mm/in)	Log-Ø D max. (mm/in)	Width E (mm/in)	Volume (m ² /ft ²)	Weight (kg/lbs)	Load capacity (kg/lbs)	Closing force (kN/lbf)
T40VHD-1,00	2590 / 102.0	2530 / 99.6	90 / 3.5	1100 / 43.3	810 / 31.9	1,00 / 10.8	1500 / 3300	6000 / 13200	45 / 9900
T40VHD-1,25	2780 / 109.4	2620 / 103.1	90 / 3.5	1200 / 47.2	810 / 31.9	1,25 / 13.5	1550 / 3410	6000 / 13200	42 / 9240
T40VHD-1,50	3130 / 123.2	2795 / 110.0	90 / 3.5	1400 / 55.1	810 / 31.9	1,50 / 16.2	1580 / 3476	6000 / 13200	37 / 8140
T40VHD-1,75	3380 / 133.1	2930 / 115.4	100 / 3.9	1500 / 59.1	810 / 31.9	1,75 / 18.8	1590 / 3498	6000 / 13200	34 / 7480
T40VHD-2,00	3650 / 143.7	3080 / 121.3	100 / 3.9	1575 / 62.0	810 / 31.9	2,00 / 21.5	1690 / 3718	6000 / 13200	31 / 6820

Package consists of: timber grab, **KINSHOFER** rotation with sturdy slewing ring and hose guard, non-return valve

Accessories

Type	Description
KM 501 RD50	upper suspension without pendulum damper
KSW21/25 cardanic	adapter for system L-Lock KMS21/25L / KHS21/25L incl. cardan link excl. pendulum damper adapters for quick change systems from other manufacturers or different sizes on request

Requirements of carrier machine

Operating pressure (open/close):	max. 35 MPa (350 bar) / 5070psi
Pump capacity (open/close):	120 - 200 l/min / 32 - 53GPM
Operating pressure (rotate):	max. 14 MPa (140 bar) / 2030psi
Pump capacity (rotate):	25 - 60 l/min / 6.5 - 16GPM

Technical drawing

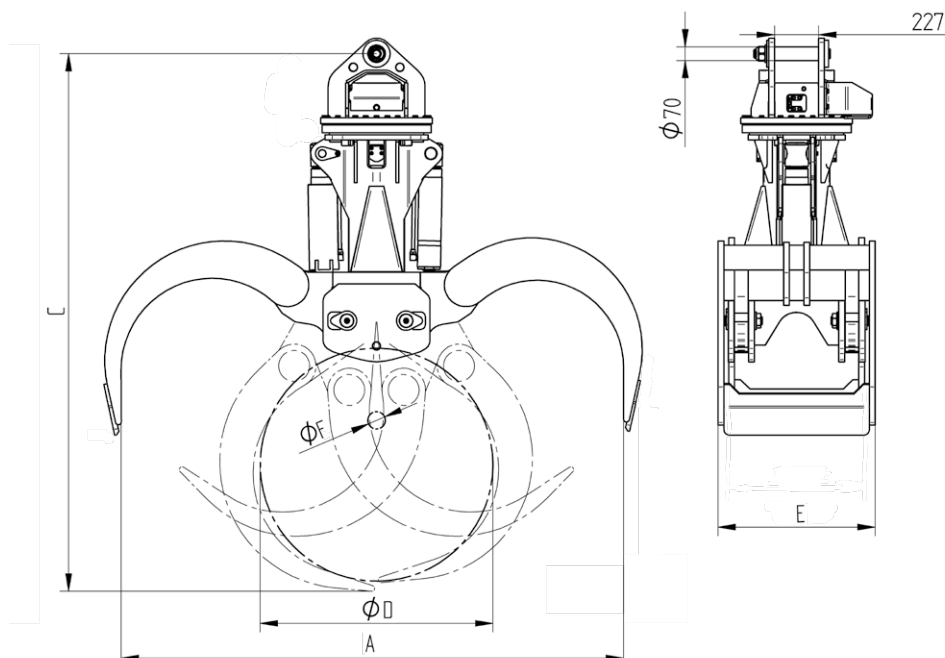

Timber grab for mobile excavators from 40t/88000lbs to 80t/176000lbs and for static excavators from 80t/176000lbs to 100t/220000lbs operating weight.

- ▷ **Long life** is ensured due to the use of 400HB steel in the manufacture of cutting edges.
- ▷ **Reduced wear** resulting from generously dimensioned bearing system.
- ▷ **Robust rotation** integrated in the center part, with hose guard.
- ▷ Optimal plunge into the log pile thanks to the **large opening**; precise positioning due to the **integrated rotation**.
- ▷ **Cylinder with end position damping**.
- ▷ **High closing forces** of up to 60kN/13200lbf at an operating pressure of 35MPa/5070psi, varies depending on width.



Timber Grab T80VHD

Type	Width	Opening	Height max.	Dimension	Volume	Weight	Load capacity	Closing force
	E (mm/in)	A (mm/in)	C (mm/in)	D (mm/in)	(m ² /cord)	(kg/lbs)	(kg/lbs)	(kN/lbf)
T80VHD-1,75	810 / 31.9	3250 / 128	3120 / 122.8	1475 / 58.1	1,75 / 1.17	2180 / 4796	15000 / 33000	60 / 13200
T80VHD-2,00	810 / 31.9	3410 / 134.3	3200 / 126	1600 / 63	2,00 / 1.34	2280 / 5016	15000 / 33000	58 / 12760
T80VHD-2,50	810 / 31.9	3770 / 148.4	3400 / 133.9	1780 / 70.1	2,50 / 1.68	2340 / 5148	15000 / 33000	52 / 11440
T80VHD-3,00	810 / 31.9	4060 / 159.8	3560 / 140.2	1950 / 76.8	3,00 / 2.01	2400 / 5280	15000 / 33000	48 / 10560

Package consists of: timber grab, **KINSHOFER** rotation with sturdy slewing ring and hose guard, non-return valve

Accessories

Type	Description
KM 501 RD120	upper suspension without pendulum damper

Requirements of carrier machine

Operating pressure (open/close):	max. 35 MPa (350 bar) / 5070psi
Pump capacity (open/close):	120 - 200 l/min / 32.0 - 53.0GPM
Operating pressure (rotate):	14 - max. 20 MPa (140 - max. 200 bar) / 2030 - max. 2900psi
Pump capacity (rotate):	25 - 60 l/min / 6.5 - 16.0GPM

Technical drawings

